

SERVICE MANUAL

FOR

MODEL WPP-531-X-ADA-STROBE

WEATHERPROOF TELEPHONE WITH OPTIONAL STROBE
FEATURE

EQUIPPED WITH SPK1.07UNVlr3 FIRMWARE



Serving the Telephone Industry Since 1930

*Communication Equipment
& Engineering Company*

519 W South Park Street

Okeechobee, FL 34972

Voice: 863-357-0798

Fax: 863-357-0006

IMPORTANT INFORMATION FOR CUSTOMER

Please fill in before you continue.

The following information is necessary when calling CEECO for assistance.

MODEL NUMBER	MODEL WPP-531-X-ADA-STROBE, EQUIPPED WITH SPK1.07UNVLr3 FIRMWARE.
SERIAL NUMBER	
DATE MANUFACTURED	
LOCATION INSTALLED	

For us to better serve you, please have this information available when calling for technical support.

CEECO *Communication Equipment & Engineering Company*

519 W South Park Street
Okeechobee, FL 34972
863-357-0798- telephone
863-357-0006- facsimile
info@ceeco.net
www.ceeco.net

CEECO
Communication Equipment & Engineering Company
PROPRIETARY

TABLE OF CONTENTS

<u>SECTION</u>	<u>PAGE</u>
1.0 INTRODUCTION	4
2.0 GENERAL DESCRIPTION	4
3.0 PROGRAMMING.....	5
PROGRAMMING CONTINUED... ..	6
PROGRAMMING CONTINUED... ..	7
PROGRAMMING CONTINUED... ..	8
4.0 TESTING/OPERATION.....	8
TESTING/OPERATION CONTINUED... ..	9
5.0 INSTALLATION NOTES AND ASSEMBLY INSTRUCTIONS.....	10
INSTALLATION CONTINUED... ..	11
6.0 SPECIFICATIONS.....	12
7.0 PARTS LIST.....	13
8.0 FCC NOTICE	14
9.0 REPAIR AND RETURN INFORMATION	15
10.0 WARRANTY POLICY	16
11.0 WIRING DIAGRAM.....	16
12.0 PROGRAMMING JUMPER DIAGRAM.....	18

1.0 INTRODUCTION

The practices in this manual provide installation and maintenance information for Model WPP-531-X-ADA-STROBE speakerphone, equipped with SPK1.07UNVLR3 firmware.

The information in this manual is subject to change without notification.

For information not included in this manual, please call or write:

CEECO
Communication Equipment & Engineering Company
Customer Service
519 W South Park Street
Okeechobee, FL 34972
863-357-0798- telephone
863-357-0006- facsimile
info@ceeco.net
www.ceeco.net

2.0 GENERAL DESCRIPTION

- 2.01 The CEECO Model WPP-531-X-ADA-STROBE Telephone is a sturdy, hands free, vandal resistant, speakerphone. The telephone is constructed with a stainless steel panel and an aluminum weatherproof housing. This telephone comes with an optional ADA feature (red/green LED) giving visual feedback during periods of operation. It also comes with an optional blue strobe light, which operates off of AC power and activates when a call is made with the phone. Instead of a hookswitch and handset, the telephone has a Press-To Start/Press-To-Stop (CALL) button for the initiation and termination of phone calls. Ordinarily, the telephone can only be used to receive calls. The telephone may, however, be used to initiate calls **if** it is used in conjunction with external call equipment (i.e. programmable switch, ring down circuit, etc...)
- 2.02 The microphone is muted during periods of dial tone to deter the use of fraudulent hand-held dialers.
- 2.03 Incoming calls may be allowed or blocked depending on the programming.
- 2.04 Programming is accomplished via the DTMF programming keypad.
- 2.05 The telephone also has an automatic call disconnect feature, which allows a selection of 1-9 minutes. When a call is made, the phone will automatically disconnect the call upon the expiration of the selected time.

3.0 PROGRAMMING

NOTE: It is recommended that you ground yourself to prevent ESD damage to the Printed Circuit Board(s).

- 3.01 Utilizing the security tool (sold separately) loosen and remove the four (4) security screws, which secure the stainless steel panel to the weatherproof housing. Carefully **remove the stainless steel panel and attached telephone assembly from the weatherproof housing.** Programming should be performed on a suitable flat working surface to avoid damage to the phone.

NOTE: Be sure to avoid contacting the printed circuit boards with metal objects, as this may cause damage to the telephone.

- 3.02 **Connect the telephone** line cord to a working telephone line.
- 3.03 Locate the **two mini-jumpers** on the large main Printed Circuit Board and place them in the “ON” position, as depicted on the last page of this manual.
- 3.04 **Press the CALL button** and wait for dial tone to begin programming.
- 3.05 Utilizing the programming keypad, **enter # 9 7 # 1 8 # to clear all** user programmable memory locations.

NOTE: Once the # key has been entered, an operator reorder signal, fast busy tone or other central office signals may be heard. Please disregard these sounds and continue programming, as they will have no affect on the programming.

PROGRAMMING CONTINUED...

3.06 If the telephone must dial a **PBX or other access number** to begin a call, **enter # 1 8 followed by the desired number**. If this is not a desired feature, please proceed to section 3.06. This PBX/Access number may range from 1-11 digits. When the CALL button is pressed the telephone will automatically dial the PBX/Access number first, followed by an approximate one (1) second pause, and then dial the auto-dial number (programmed in the next section-3.06). A “1” must be entered under Digit 8 in section 3.08 in order to activate this feature.

EXAMPLE: Enter # **1 8 9**. This will cause the phone to automatically dial the number “9”, when the CALL button is pressed. This will be followed by an approximate one (1) second pause and then the auto-dial number will be released.

#18 _ _ _ _ _

3.07 In order to program an **auto-dial number**, **enter # 1 9, followed by the desired number**. This number may range from 1-11 digits. When the CALL button is pressed, this number will automatically dial out. Any PBX/Access number previously programmed will dial out first, followed by an approximate one (1) second pause, followed by this auto-dial number.

Example: Enter # **1 9 5 5 5 1 2 1 2**. This will program the telephone to automatically dial the number 555-1212, when the CALL button button is pressed.

#19 _ _ _ _ _

PROGRAMMING CONTINUED...

- 3.08 **Enter # 0 0 followed by a series of ten (10) digits selected from the options below.** Some of the digits allow a choice and others simply provide an arbitrary number. An entry must be made for each of the ten digits, in order for the phone to be properly programmed.

#00:

Digit 1

1 **Always 0** for this model.

Digit 2

0 **No** incoming calls allowed.

1 Incoming calls allowed.

Digit 3

0 No conversation time-out.

1-9 Minute(s) conversation time-out.

Digit 4

0 **Always 0** for this model.

Digit 5

0 **Always 1** for this model.

Digit 6

9 **Always 9** for this model.

Digit 7

0 **Always 0** for this model.

Digit 8

0 **Always 0** for this model

Digit 9

0 **Always 0** for this model

Digit 10

0 No wink detect.

1-9 Length of the wink detect.
(1=50ms incremental to 450 ms. **5 is recommended**).

PROGRAMMING CONTINUED...

- Be sure to log your entries here for future reference:

0 0 0 0 1 9 0 0 0 5
 1 2 3 4 5 6 7 8 9 10

EXAMPLE: Dial #00 0060190005. The telephone will be set as follows:

- Digit 1- Always 0.
- Digit 2- NO incoming calls allowed.
- Digit 3- 6 minute conversation time out.
- Digit 4- Always 0.
- Digit 5- Always 1.
- Digit 6- Always 9, ADA feature activated.
- Digit 7- Always 0.
- Digit 8- Always 0.
- Digit 9- Always 0.
- Digit 10- 250 Ms wink detect.

- 3.09 **Press the "CALL" button** to hang up the phone and return the **mini-jumpers** to the **"OFF"** position, as depicted on the last page of this manual.

4.0 TESTING/OPERATION

- 4.01 With the telephone connected to a working telephone line, press the "CALL" button located on the front of the telephone. Or, place a call to the phone and answer it in the same manner. The telephone will function as per the application (i.e. ring down connect or receive). The LED will illuminate red at this time. The blue strobe light will not function until AC power has been supplied to the phone (see section 7.0). When AC power is available, the strobe light will activate when the CALL button is pressed and it will stay activated until the call is terminated. The LED will flash red and green to indicate ringing. Once establishing that the call has been answered, the LED will illuminate steady green. The call is terminated when the CALL button is pressed again, when the automatic call disconnect time limit expires, or when the far end hangs up returning a wink back on the line.
- 4.04 When the call is complete, press the "CALL" button again to hang up the phone. The call will be terminated and the LED will go out. If an automatic call disconnect was programmed, allow the conversation to continue past the set time (1-9 minutes). Once the time limit expires, the phone will automatically disconnect the call. A three-tone error signal will be heard as the call is disconnected. The time is not exact. If the automatic call disconnect feature does not work properly, please repeat sections 3.02, 3.03, 3.04, 3.08, and 3.10 only. If trouble is still experienced, please refer to section 11.02.

TESTING/OPERATION CONTINUED...

- 4.06 Testing is now complete. If any trouble was encountered that has not been remedied, please refer to section 11.02 of this manual, otherwise the phone is ready for operation.

NOTE: CEECO can not be responsible for the called party's response regarding ADA features and compliance, and emergency response.

- 4.07 Carefully return the telephone assembly to the weatherproof housing. Secure it in place using the four (4) security screws and security tool. If the telephone has not yet been installed at its intended location, please refer to section 7.0, before performing this step.

5.0 INSTALLATION NOTES AND ASSEMBLY INSTRUCTIONS

*****WARNING*****

- A. Never install telephone wiring during a lightning storm.**
- B. Never install telephone jacks in wet locations unless the jack is specifically designed for wet locations.**
- C. Never touch uninsulated telephone wires or terminals unless the telephone line has been disconnected at the network interface**
- D. Use caution when installing or modifying telephone lines.**
- E. DO NOT APPLY A/C POWER WHILE INSTALLING TELEPHONE.**

5.01 Recommended tools and test equipment:

CEECO Security Tool, 301-064 Flat blade or Phillips head screw driver
Wire Strippers

- 5.02 Using a 301-064 security tool (sold separately) loosen and remove the four (4) security screws. Separate the faceplate assembly from the weatherproof housing by pulling the faceplate forward.
- 5.03 Run the inside station wire into the enclosure and terminate on the RJ11C modular jack inside, as depicted on the following page. The CEECO-provided jack must be used as it contains required over-voltage protection. Mount the housing in the intended location using the four mounting holes provided. There is a pole-mounting bracket available, which is sold separately.
- 5.04 The use of a gas tube station protector is recommended. The station ground should not exceed 50 ohms.

INSTALLATION CONTINUED...

- 5.05 Run an AC line cord into the weatherproof housing. Only a licensed electrician should install the AC line, and this should be done in accordance with all applicable codes and regulations. Locate the strobe light wire leads within. Attach the AC line cord as illustrated on **page 17** of this manual. Be sure to make all connections A, B, C, and D as illustrated. The other connections should already have been made as shown. CEECO utilizes two different style of strobe lights due to special considerations. If you have one that appears different from the illustration, the wiring will be the same with the exception of one ground wire lead. One of the strobe light models comes with it its own independent ground wire. The other does not. Please contact CEECO with any questions. Be certain to seal any open gaps on housing, when wiring is completed, in order to maintain the weatherproof integrity. Water can follow wires into openings if not properly sealed. Simple silicone sealer is normally sufficient.
- 5.06 Plug the modular line cord from the faceplate assembly into the RJ11C terminal block. Dress the line cord away from the security screws and seat the faceplate into the weatherproof housing.
- 5.07 Carefully return the telephone assembly to the housing, securing it in place with the four (4) security screws and security tool.
- 5.08 Telephone line wiring for modular jack:

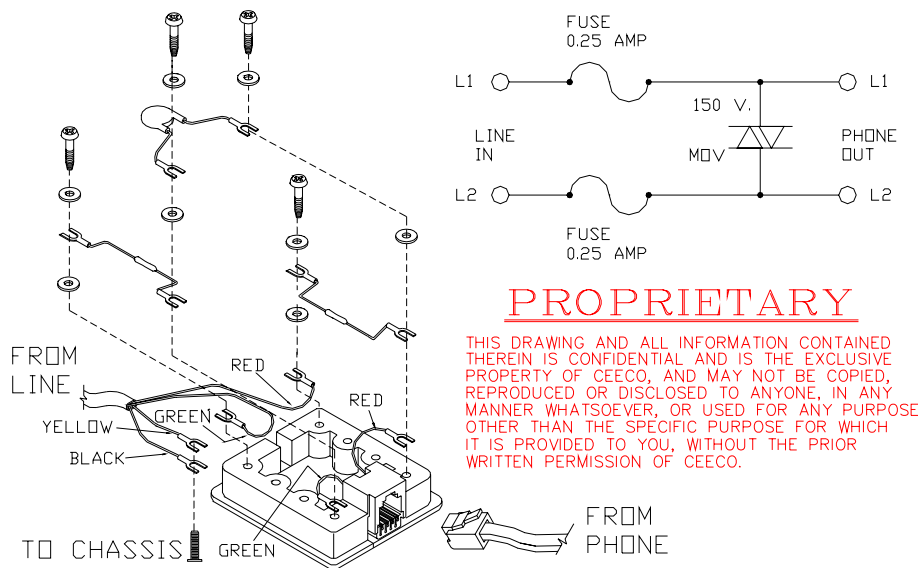

6.0 SPECIFICATIONS

INPUT POWER:	C.O. Line powered/120VAC Strobe power.
LOOP CURRENT:	33mA minimum 80mA maximum
IMPEDANCE:	600 ohms
SIGNALING:	DTMF, 70ms tone, 55 ms spacing
OUTPUT:	-4.0dbm to -6.0dbm
RINGER EQUIVALENCY	0.4A
ENVIRONMENTAL:	Temperature 0° C to 50° C Humidity 20% - 90% non condensating
PROGRAMMING:	Via DTMF keypad or remotely thru phone line.
WEIGHT:	Approximately 16 Pounds
DIMENSIONS:	9" Wide x 13" High x 8.5" Deep
TYPE JACK:	RJ11C
U.L. LISTED NO.:	60F5
FCC REGISTRATION	BW8USA-73021-MT-E

7.0 PARTS LIST

<u>QUANTITY</u>	<u>PART NUMBER</u>	<u>DESCRIPTION</u>
4	331-006	OUTER COVER SECURITY SCREW
1	301-018	MODULAR LINE CORD
1	301-054UL	MODULAR CONNECTOR (RJ11C)
1	700-008	KEYPAD CABLE
1	660-000	CEECO SPEAKER BOARD
1	705-110	CONNECTORIZED KEYPAD
2	6020	MOMENTARY PANEL SWITCH
1	14123	SPEAKER
1	14067	MICROPHONE
1	331-005	WEATHERPROOF HOUSING
<u>ACCESSORIES:</u>		
1	301-064	SECURITY TOOL

8.0 FCC NOTICE

8.01 FCC REGISTRATION AND REPAIR INFORMATION

Your new telephone has been registered with the Federal Communication Commission (FCC) in accordance with Part 68 of its rules. The FCC requires that you be advised of certain requirements involving the use of this telephone.

8.02 CONNECTION WITH THE NATIONWIDE TELEPHONE NETWORK

The FCC requires that you connect this telephone to the Nationwide Telephone Network through a registered jack provided by the Telephone Company in your area. This jack is a modular outlet, which you can order from your local telephone company.

8.03 NOTIFICATION TO THE TELEPHONE COMPANY

Before connecting this telephone, the FCC requires that you notify your local telephone company business office. The number is in the front of your phone book.

Tell them:

The "line" to which you will connect the telephone (that is, your phone number) and the telephone's FCC registration number and ringer equivalence number. These numbers are listed in Section 8.0.

The FCC further requires that you notify your local telephone company when permanently disconnecting this telephone.

9.0 REPAIR AND RETURN INFORMATION

9.01 WARRANTY REPAIR

Any device returned requiring warranty service, repair or credit must be accompanied with a "Return Material Authorization" (RMA) Form. It must include return shipping instructions, original purchase order number and special marking instruction. A description of the trouble observed must be attached to the defective unit. This information must be inside the shipping container.

9.02 DIRECT ALL INQUIRES TO:

CEECO

Repair Department

863-357-0798- telephone

863-357-0006- facsimile

info@ceeco.net

www.ceeco.net

9.03 NON-WARRANTY REPAIR

CEECO will repair equipment out of warranty for a set charge, plus parts. The customer must pay the shipping costs in both directions.

9.04 RETURN FOR CREDIT

Material may be returned for credit only with prior approval. Material authorized for return is subject to a 20% restocking charge based on the manufacturer's list price. Return RMA must be requested no later than 30 days after original shipment.

10.0 WARRANTY POLICY

10.01 GENERAL

CEECO products are guaranteed to be free of defects in material and workmanship for a period of 365 days from the date of original purchase. CEECO's obligation under this warranty is limited to repair or replacement of any part found to be defective by CEECO. Under no circumstances shall CEECO be liable for loss, damage, cost of repair or consequential damages of any kind, which have been caused by neglect, acts of God, abuse or improper operation of equipment.

10.02 PRINTED CIRCUIT BOARDS

Printed circuit boards should not be repaired in the field. If a unit is found to be faulty, replace it with another unit and return the faulty unit to CEECO for repair. Modifications by anyone other than CEECO will void the warranty.

11.0 WIRING DIAGRAM

*******WARNING*******

**THE INSTALLATION OF A/C LINES SHOULD ONLY BE DONE
BY A LICENSED AND QUALIFIED ELECTRICIAN, IN
ACCORDANCE WITH ALL APPLICABLE CODES AND
REGULATIONS.**

Continued.....

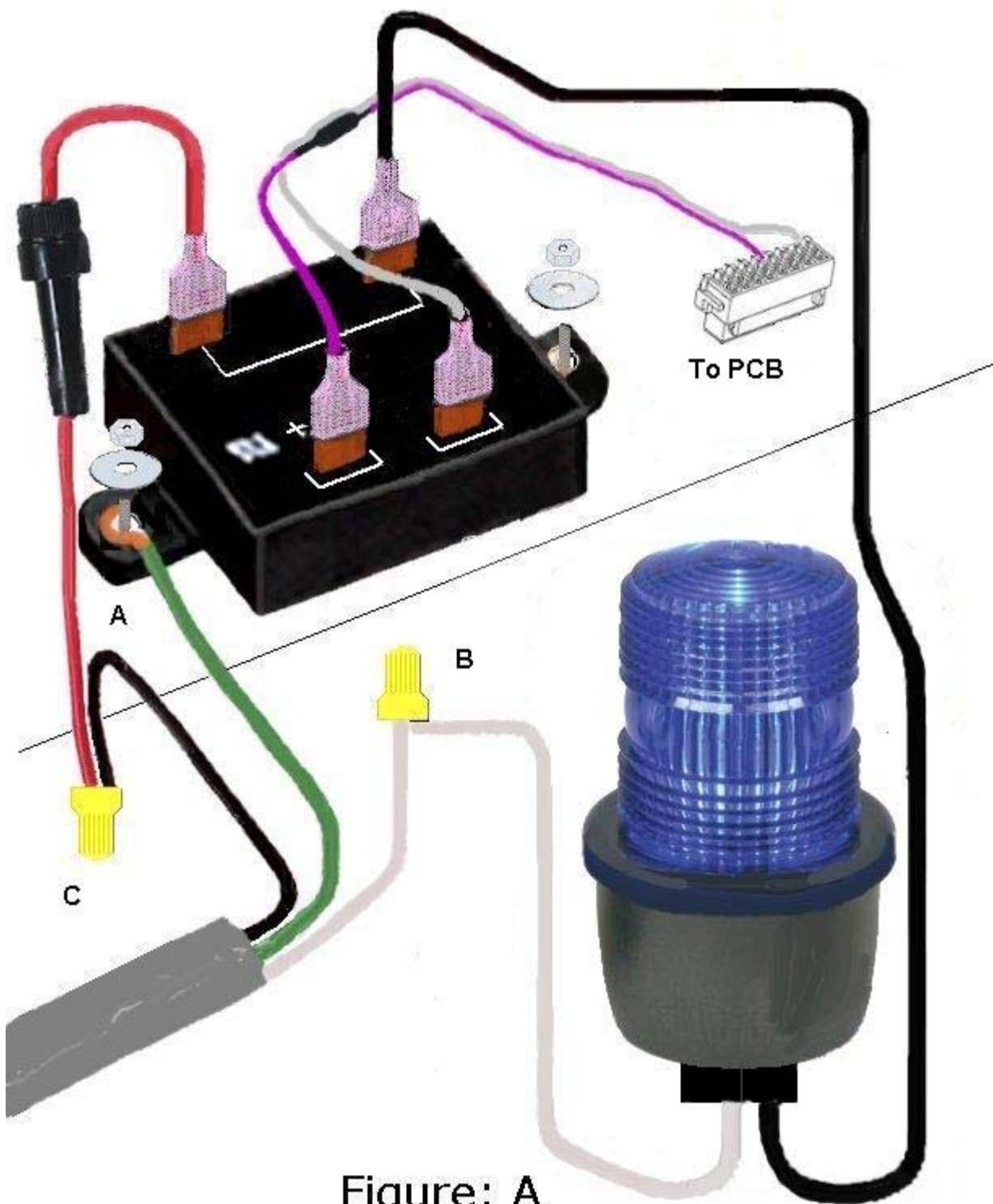
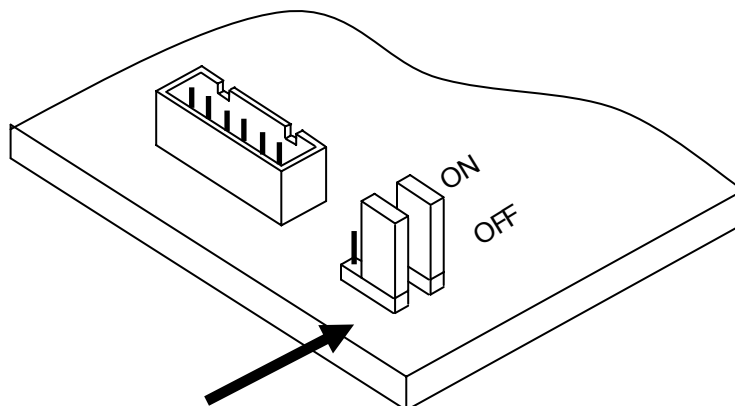

Figure: A

PROGRAMMING JUMPER DIAGRAM

Locate the mini jumpers on the corner of the PCB.



Move the **mini jumpers** to the **ON** position **BEFORE** going off-hook.

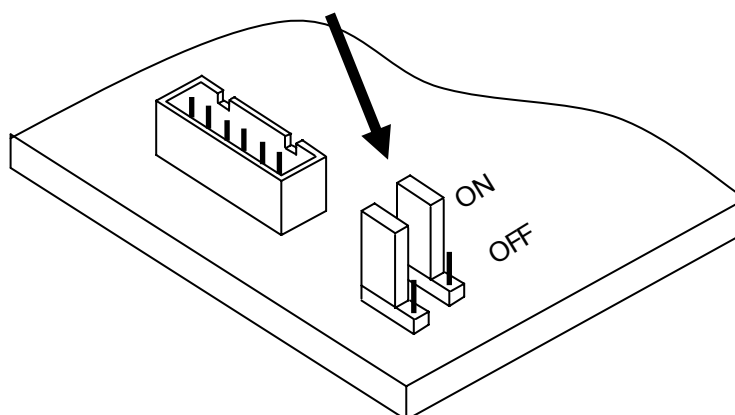

When programming is completed, move the **mini jumpers** to the **OFF** position.

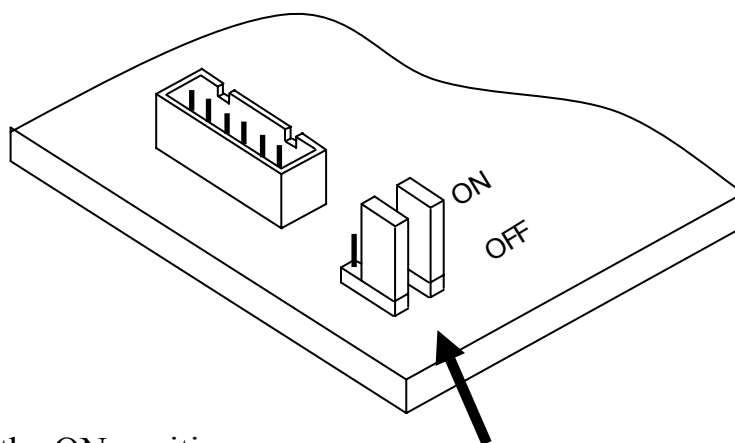

NOTE:

Do not leave the mini jumpers in the ON position; this will decrease battery life.